

2

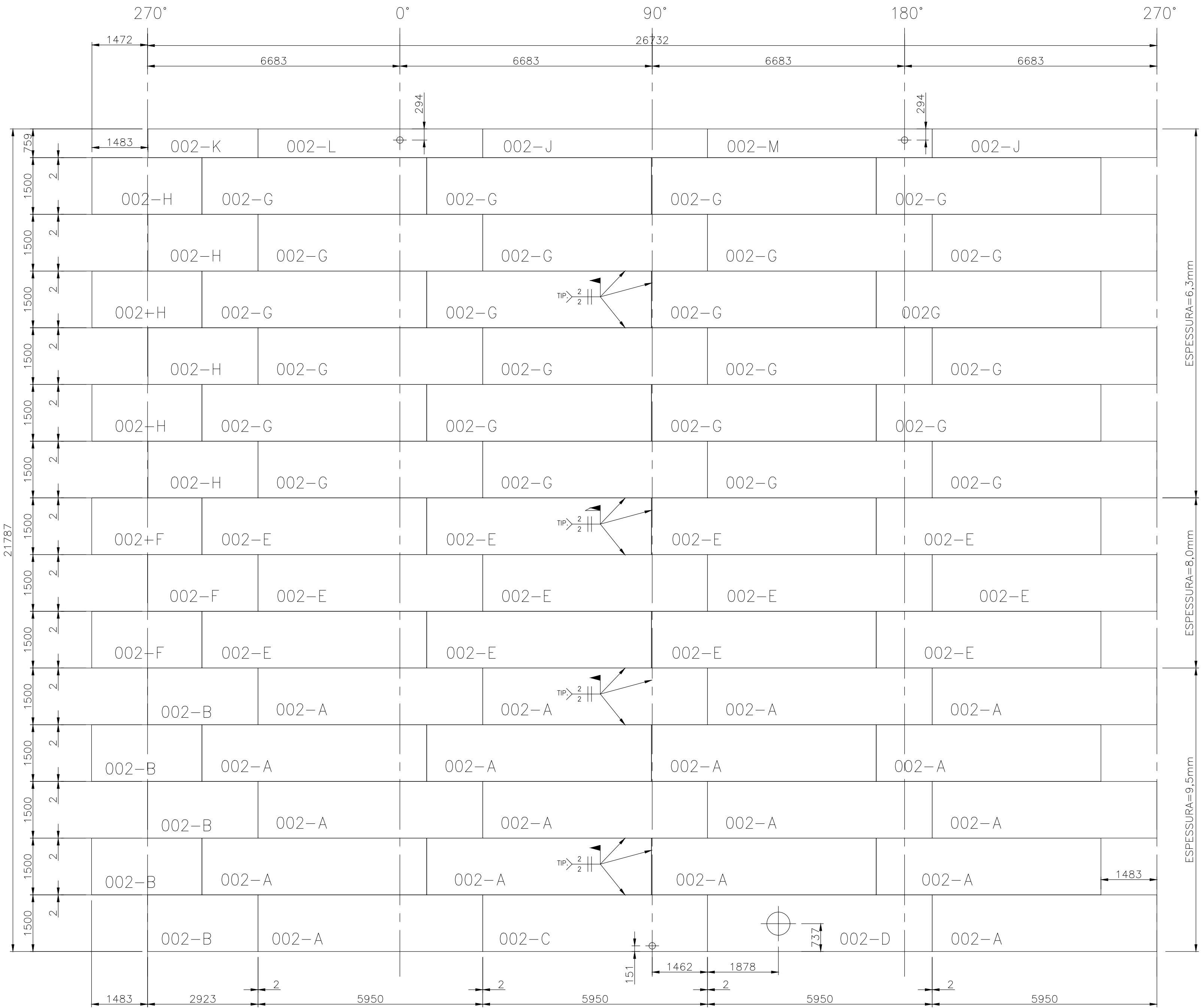

COSTADO DO TANQUE - PLANIFICADO VISTA FACE INTERNA
ESC. 1:75

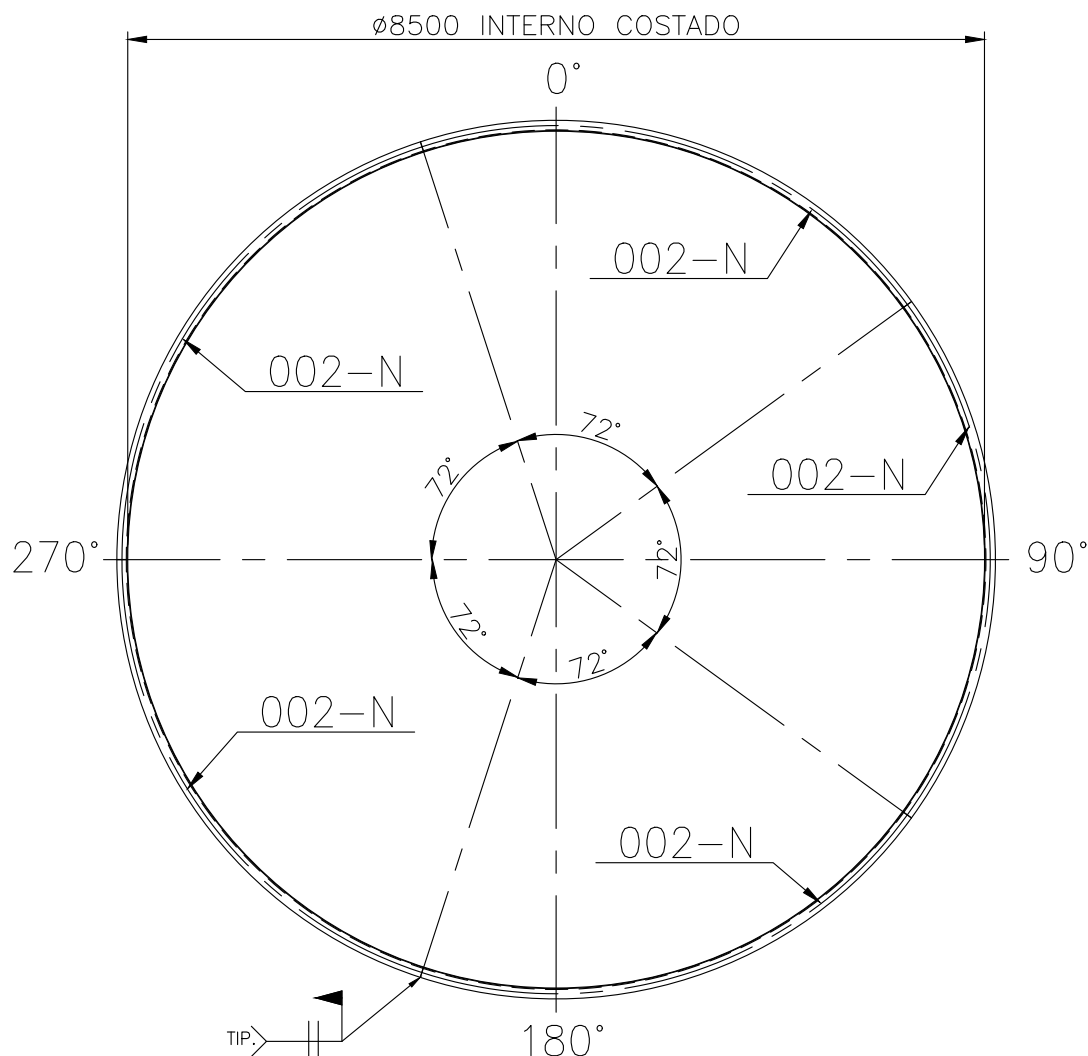

COSTADO DO TANQUE - VISTA SUPERIOR
ESC. 1:75

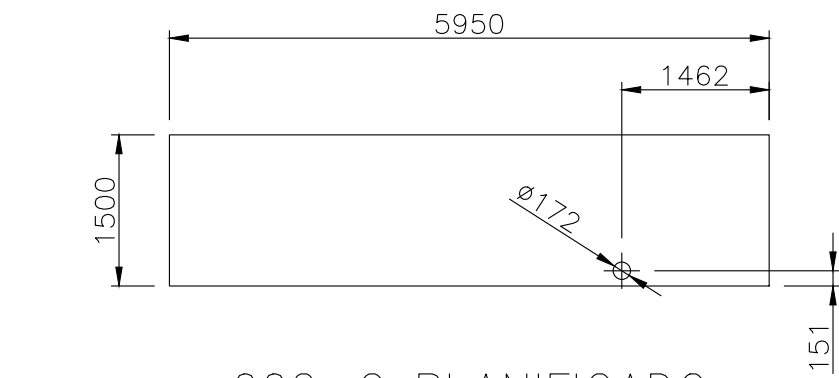

002-C PLANIFICADO
ESC. 1:75

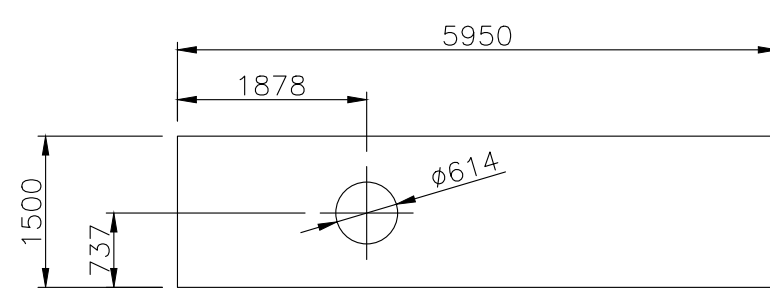

002-D PLANIFICADO
ESC. 1:75

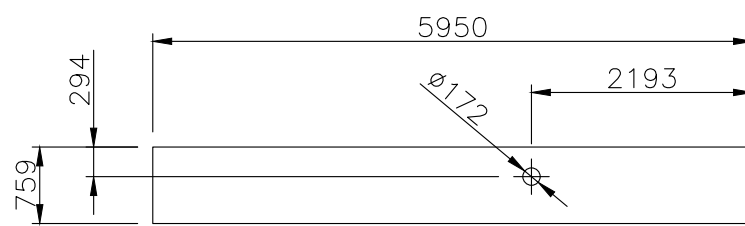

002-L PLANIFICADO
ESC. 1:75

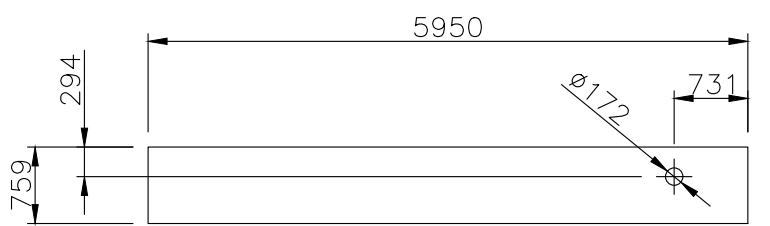

002-M PLANIFICADO
ESC. 1:75

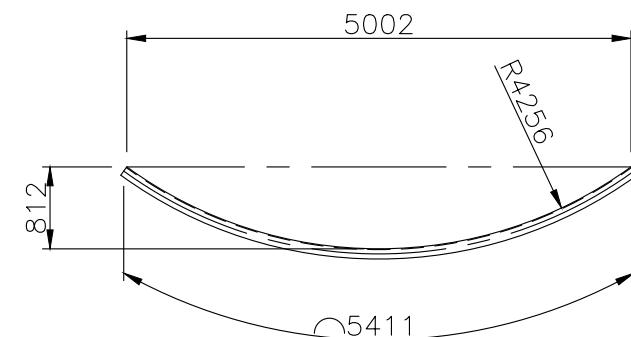

002-N
ESC. 1:75

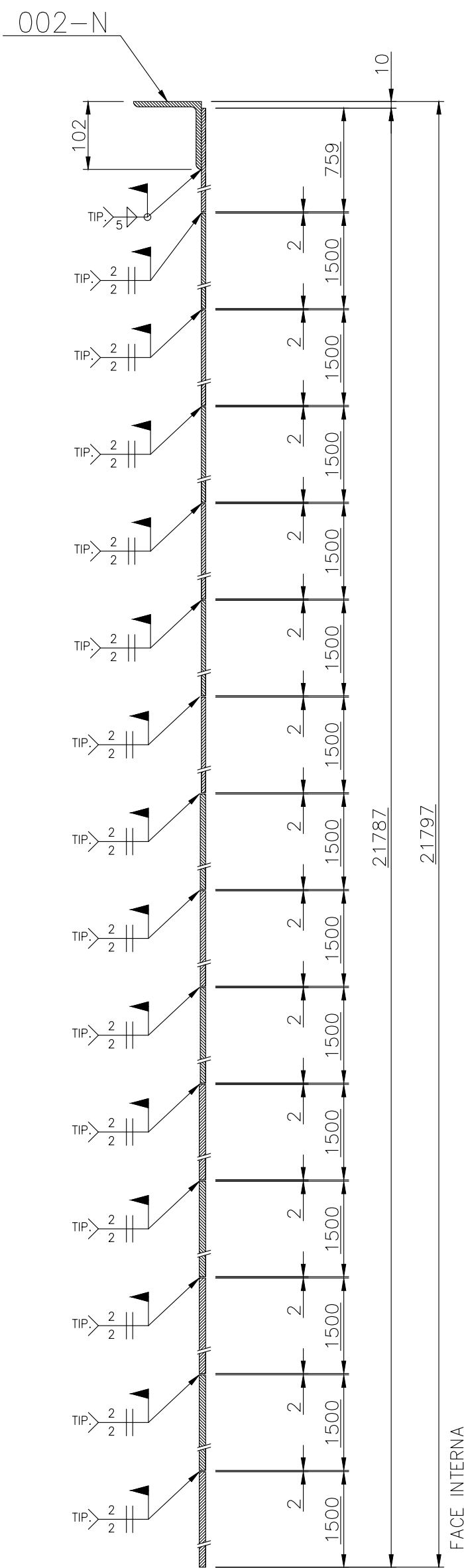

COSTADO - CORTE TÍP.
ESC. 1:7,5

LISTA DE MATERIAIS

ITEM	QTD.	DESCRIÇÃO	MATERIAL	PESO	NORMA OU OBS.
COSTADO					
002-A	18	CH. 9.5 x 1500 x 5950	ASTM A36	12011,4	-
002-B	05	CH. 9.5 x 1500 x 2923	ASTM A36	1639,0	-
002-C	01	CH. 9.5 x 1500 x 5950	ASTM A36	667,3	-
002-D	01	CH. 9.5 x 1500 x 5950	ASTM A36	667,3	-
002-E	12	CH. 8.0 x 1500 x 5950	ASTM A36	6726,0	-
002-F	03	CH. 8.0 x 1500 x 2919	ASTM A36	825,0	-
002-G	24	CH. 6.3 x 1500 x 5950	ASTM A36	10677,6	-
002-H	06	CH. 6.3 x 1500 x 2913	ASTM A36	1306,8	-
002-J	02	CH. 6.3 x 759 x 5950	ASTM A36	450,2	-
002-K	01	CH. 6.3 x 759 x 2913	ASTM A36	110,2	-
002-L	01	CH. 6.3 x 759 x 5950	ASTM A36	225,1	-
002-M	01	CH. 6.3 x 759 x 5950	ASTM A36	225,1	-
REFORÇO SUPERIOR					
002-N	05	L 101.6 x 8.0 x 5411	ASTM A36	335,0	-
PESO TOTAL = 35866,0 kg					

E

FORMATO - A1
B41x584mm